

STEP 1

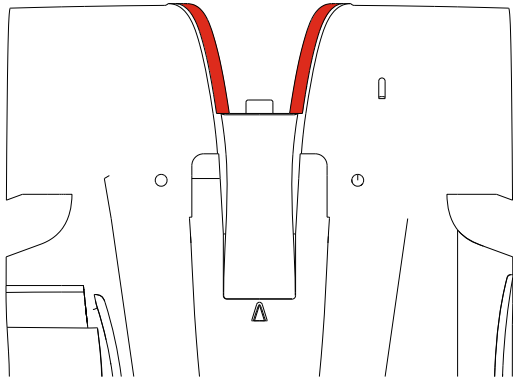

plastic part
BOTTOM VIEW

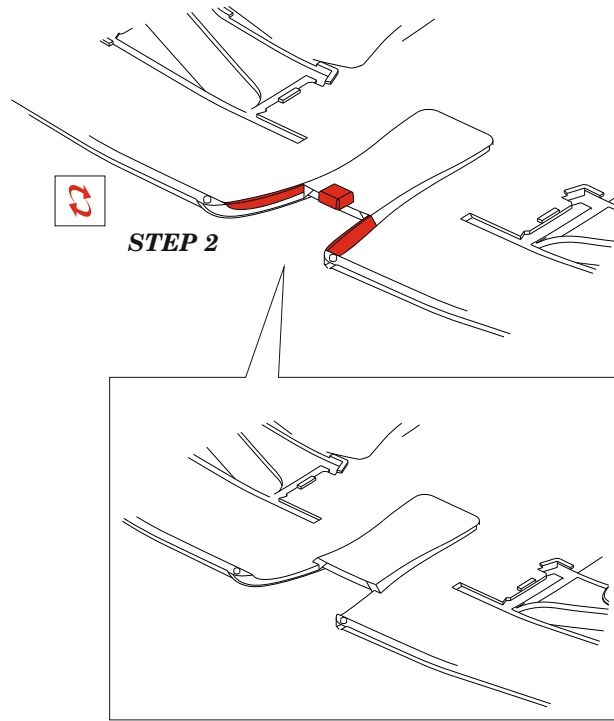

STEP 2

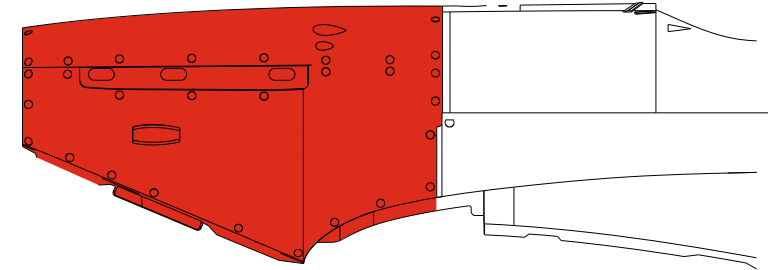

plastic part

A

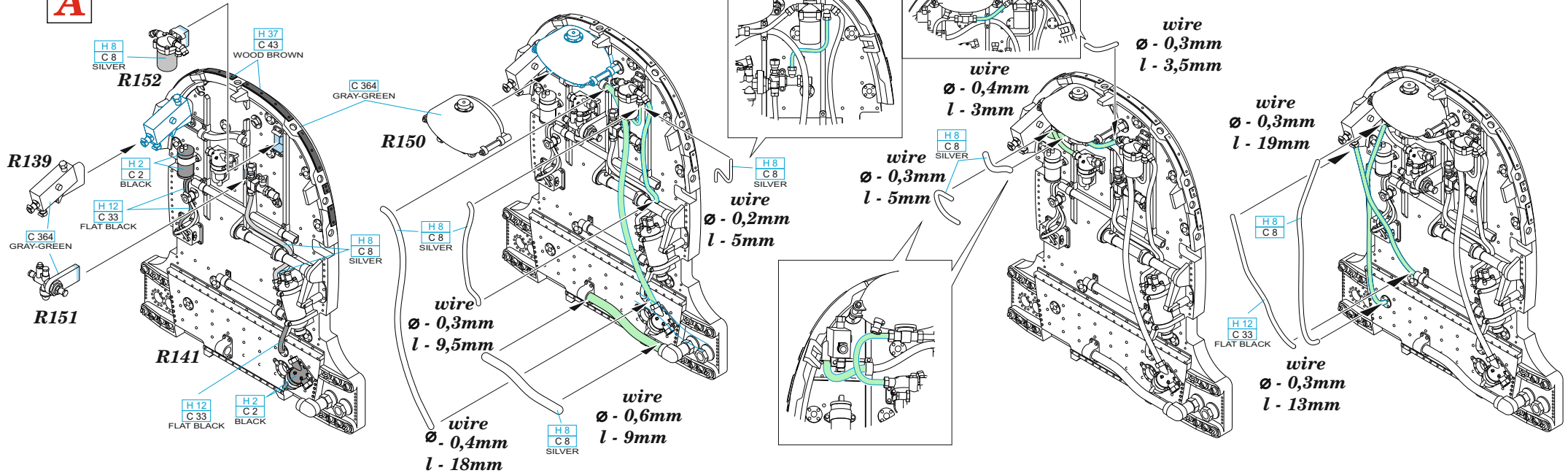

B

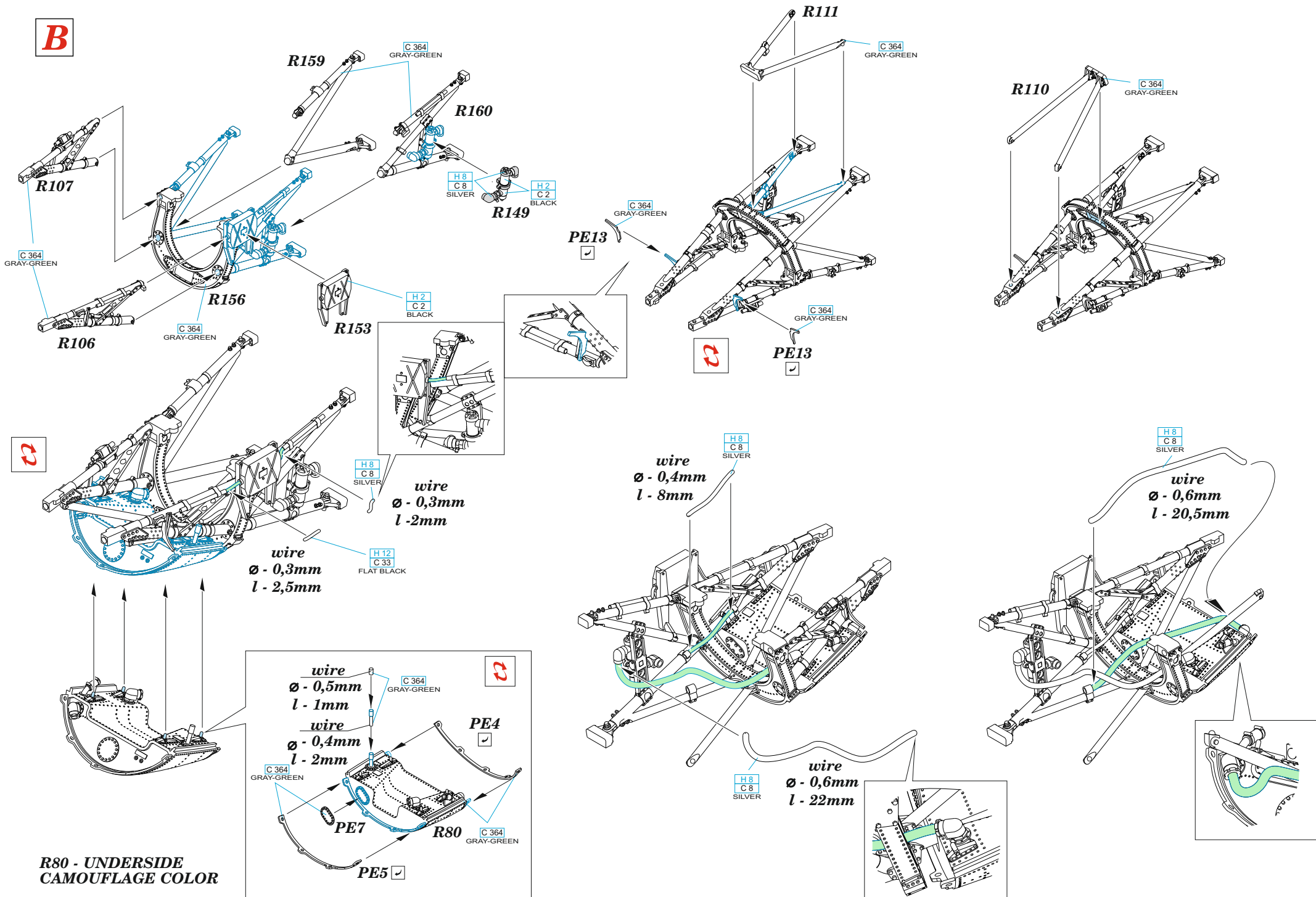

R80 - UNDERSIDE CAMOUFLAGE COLOR

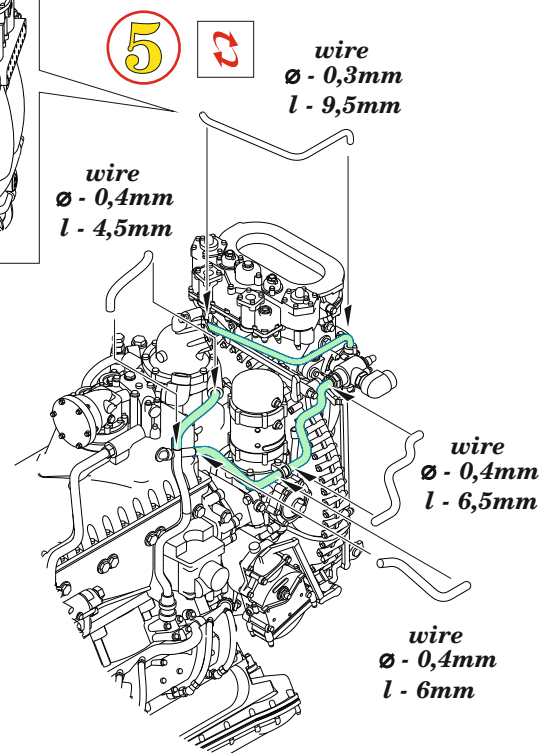
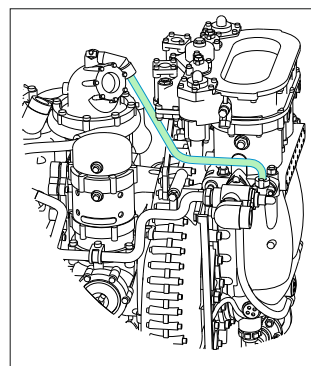
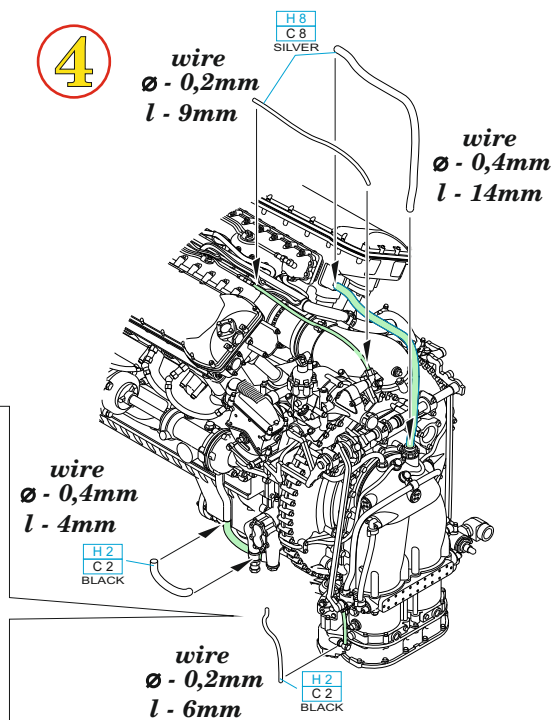
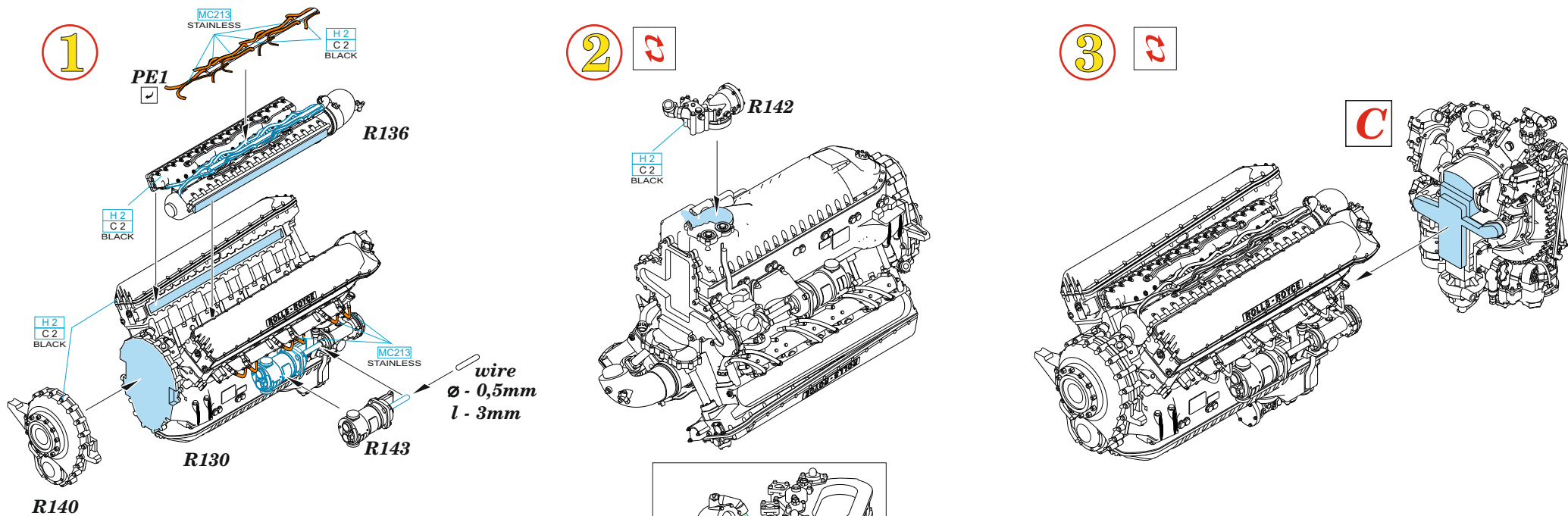

REMOVE ODSTRANIT	BEND OHNOUT
GRIND OBROUSIT	OPTION VOLBA
DRILL HOLE VRTAT OTVOR	REPLACE NAHRADIT
SYMMETRICAL ASSEMBLY SYMETRICKÁ MONTÁŽ	
SCRIBE THE PANEL AND HOLES RYTI	
REVERSE SIDE OTOČIT	

6

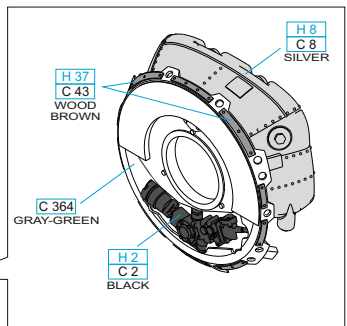
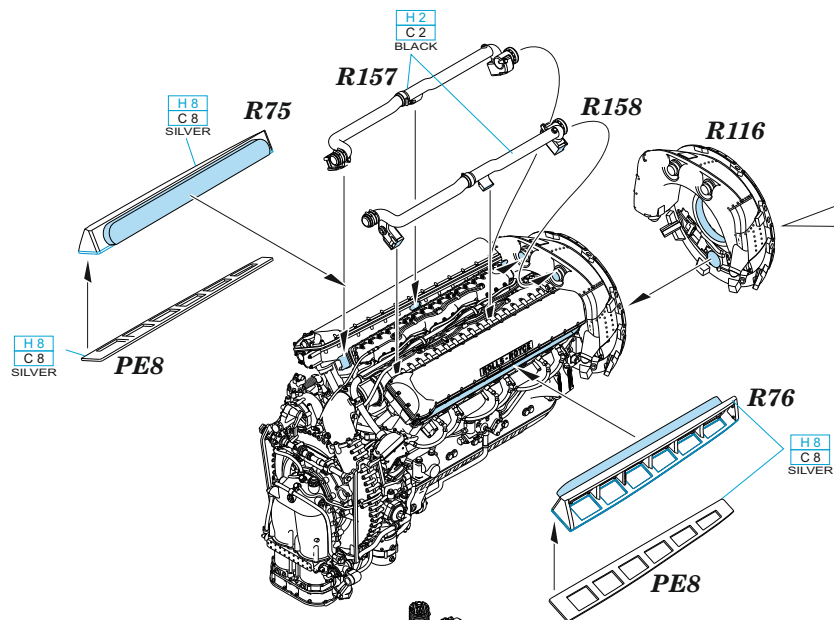

7

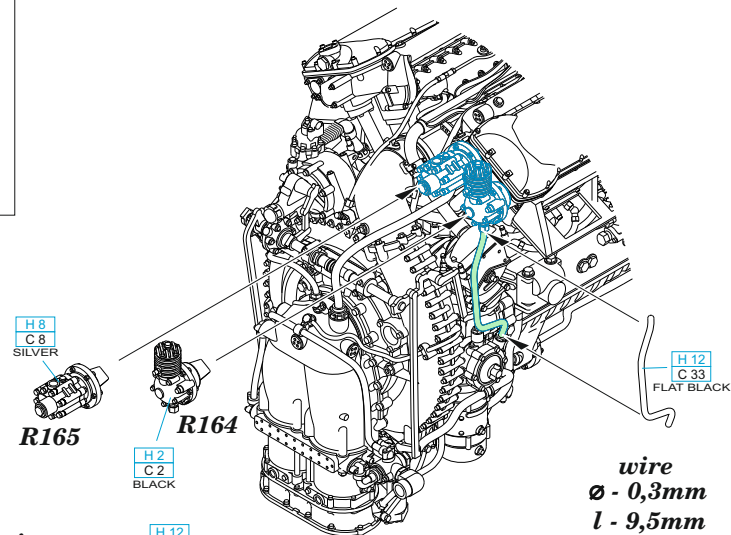

8

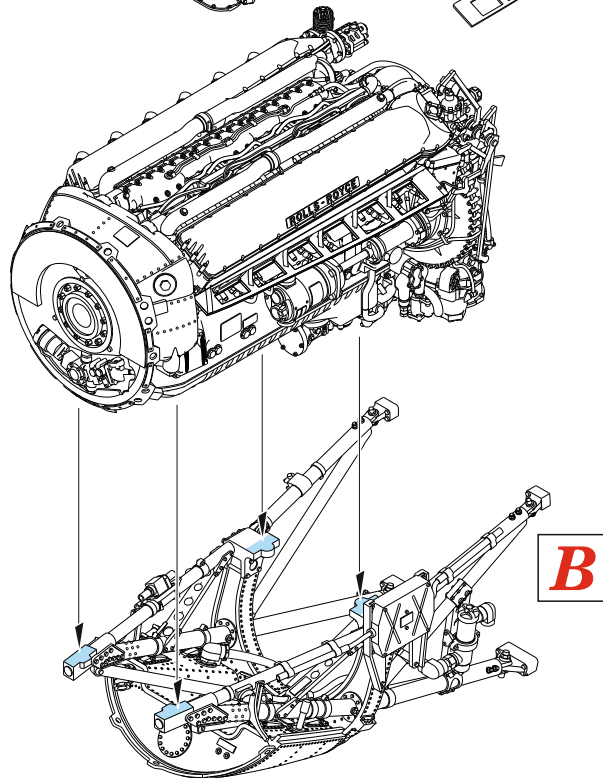

9

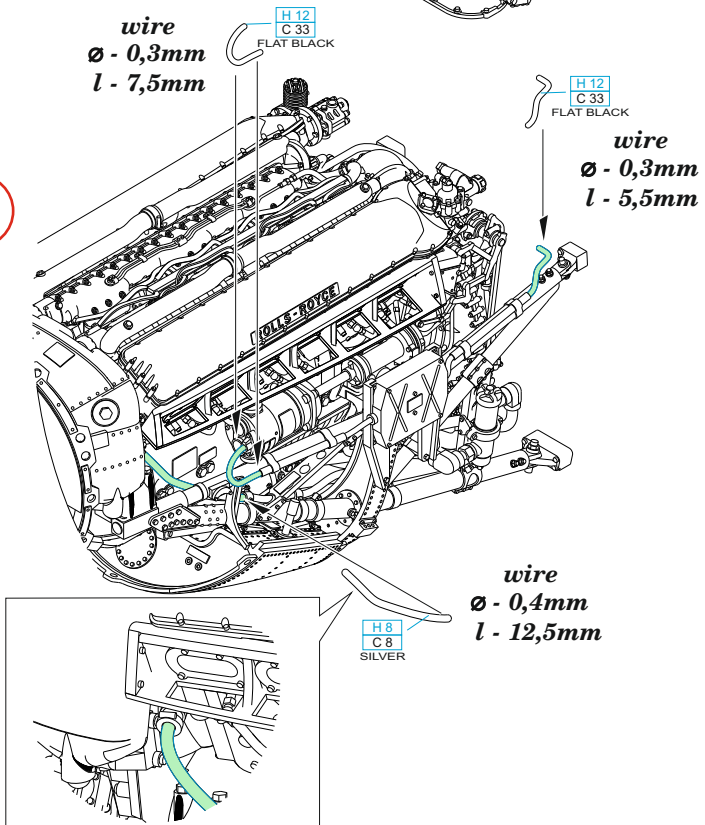

10



wire
Ø - 0,3mm
l - 13mm

H8
C8
SILVER

H12
C33
FLAT BLACK

wire
Ø - 0,6mm
l - 10mm

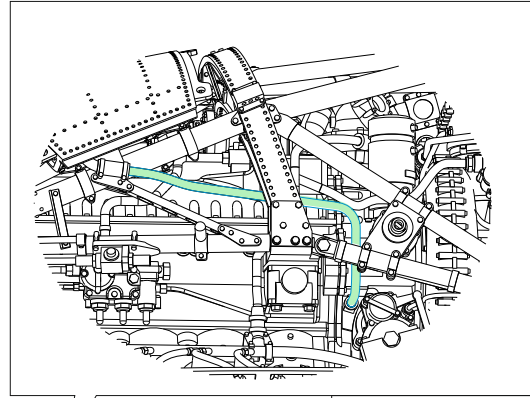
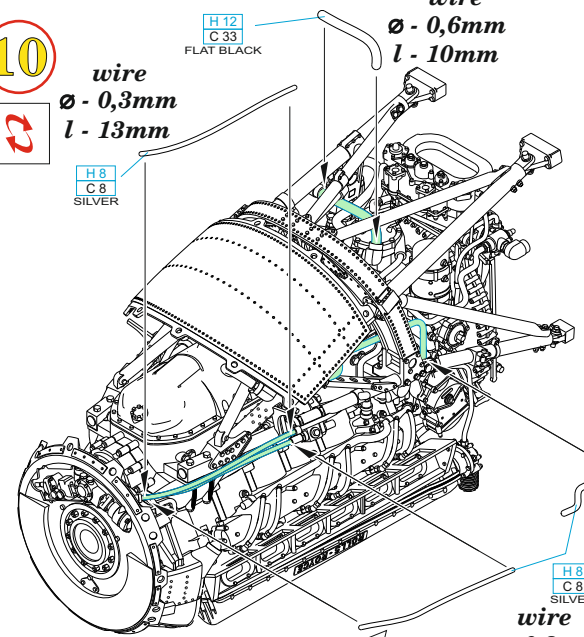

wire
Ø - 0,4mm
l - 18mm

H8
C8
SILVER

wire
Ø - 0,3mm
l - 12,5mm

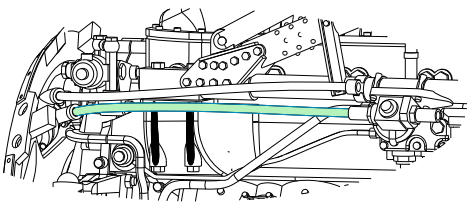

12

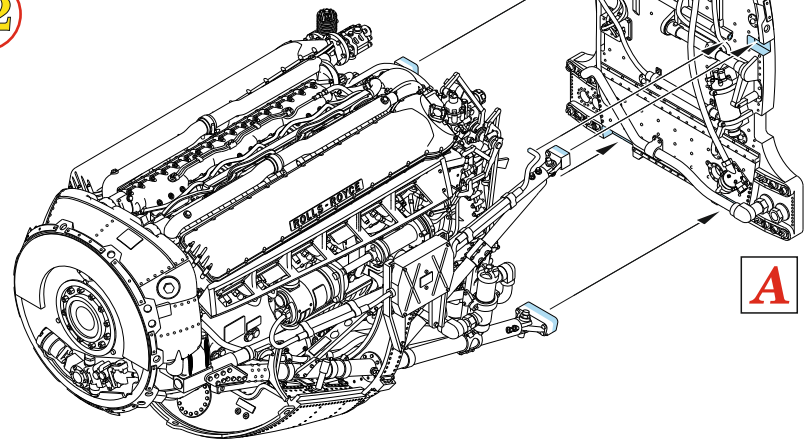

A

11



PE17

H2
C2
BLACK

H2
C2
BLACK

PE10

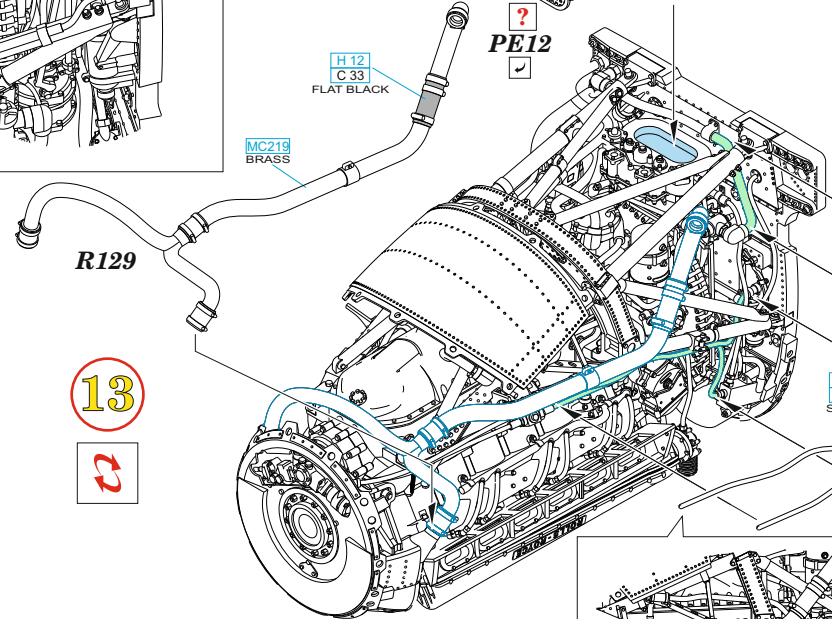
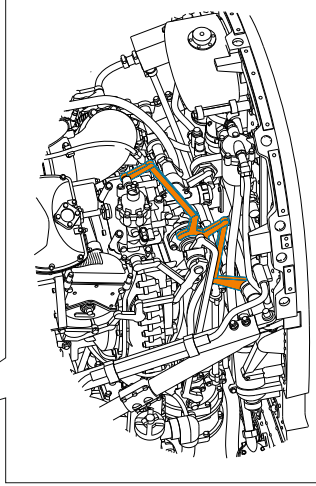

CAMOUFLAGE
COLOR

R147

PE12

H12
C33
FLAT BLACK

MC219
BRASS

R129

13



H12
C33
FLAT BLACK

wire
Ø - 0,6mm
l - 8,5mm

wire
Ø - 0,3mm
l - 24mm

H8
C8
SILVER

wire
Ø - 0,3mm
l - 21mm

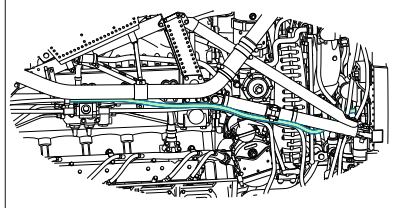

14

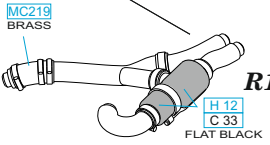
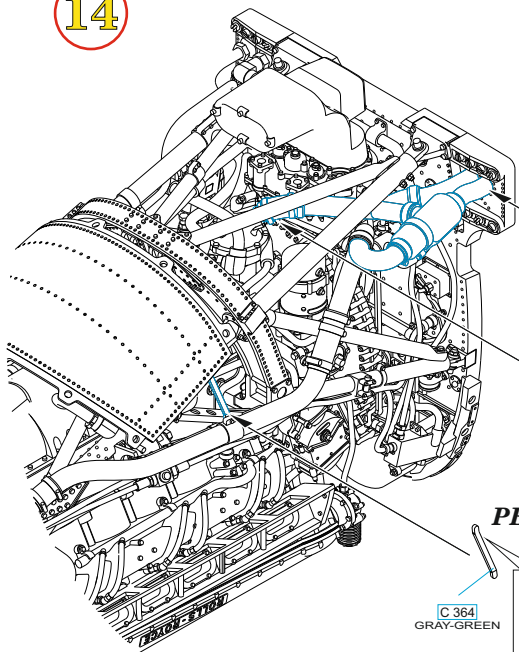

15

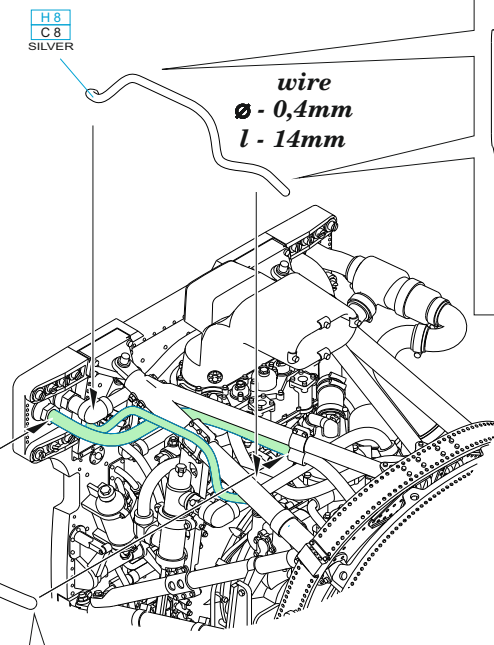

H8
C8
SILVER

wire
Ø - 0,4mm
l - 14mm

H8
C8
SILVER

wire
Ø - 0,6mm
l - 14mm

PE18

C 364
GRAY-GREEN

H2
C2
BLACK

wire
Ø - 0,4mm
l - 12mm

wire
Ø - 0,4mm
l - 10mm

16

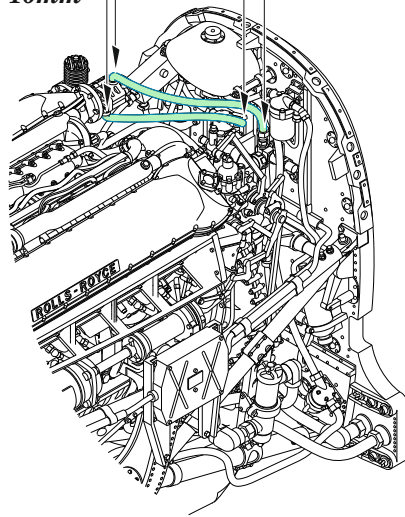

17

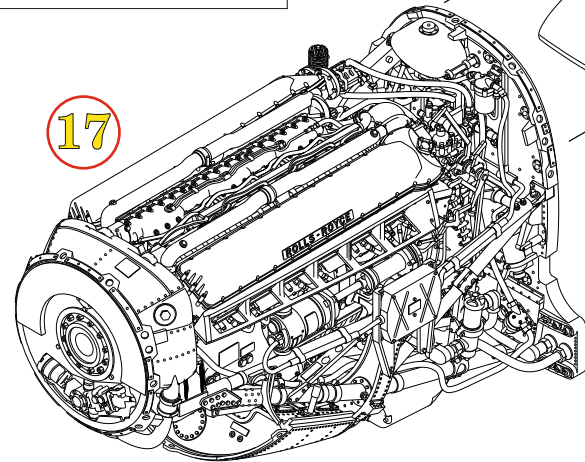

H8
C8
SILVER

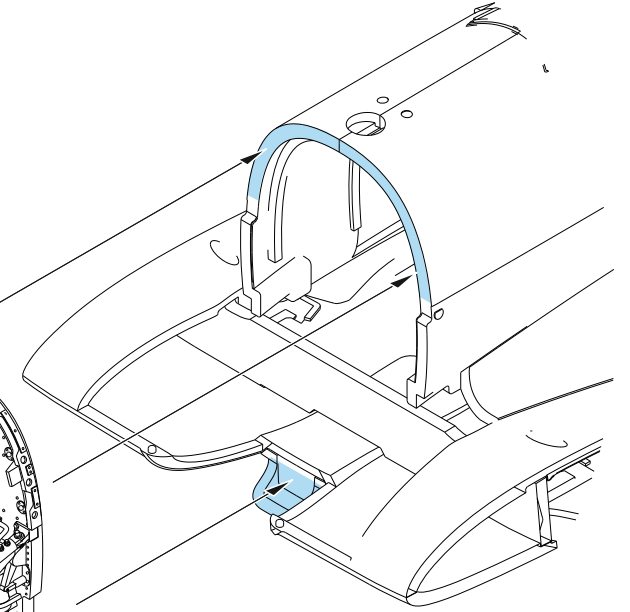
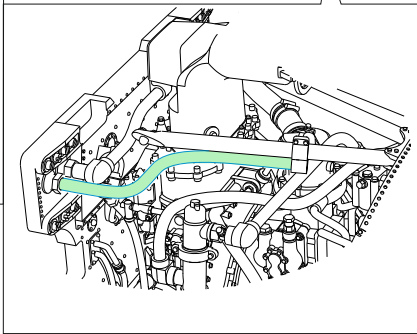
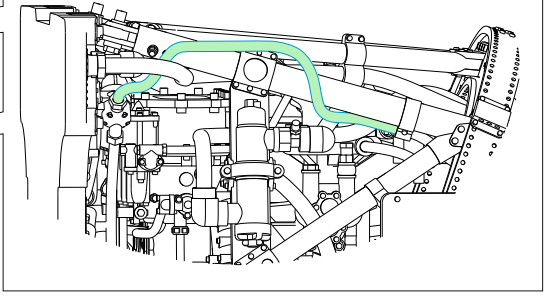

plastic parts

18

plastic parts

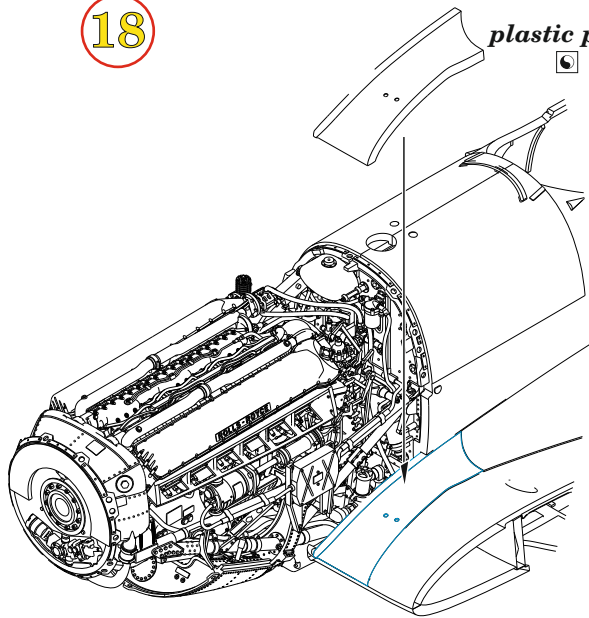

19

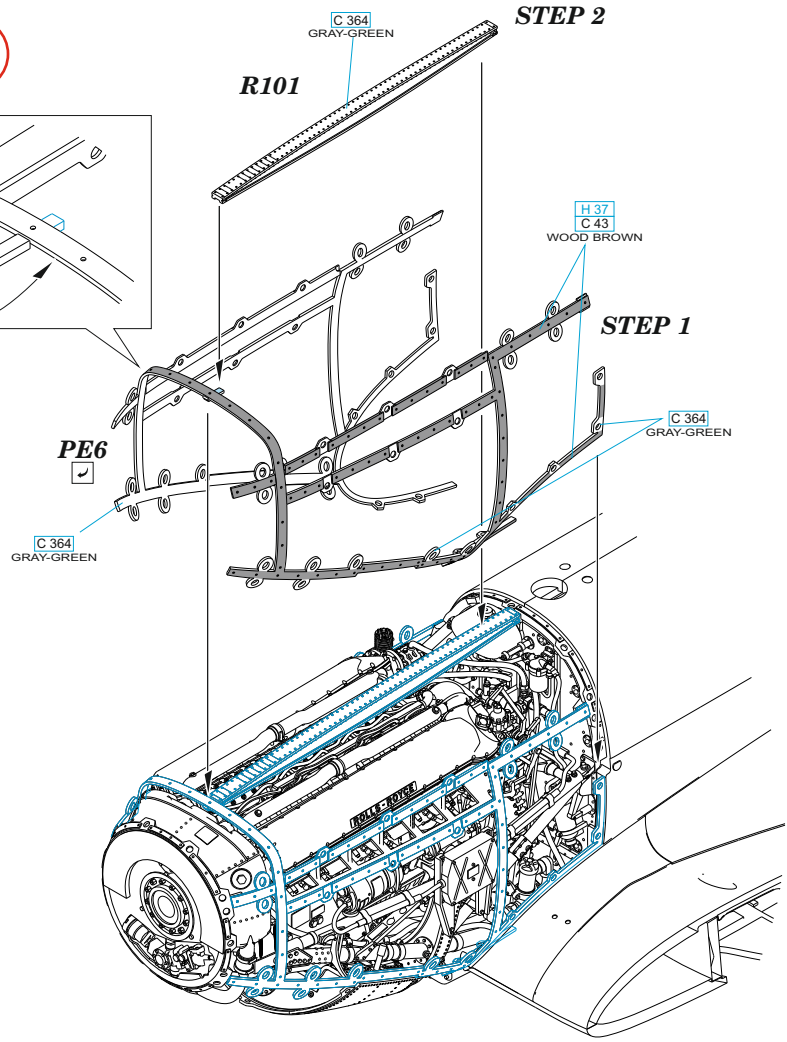
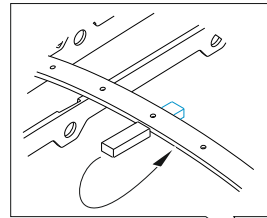

20

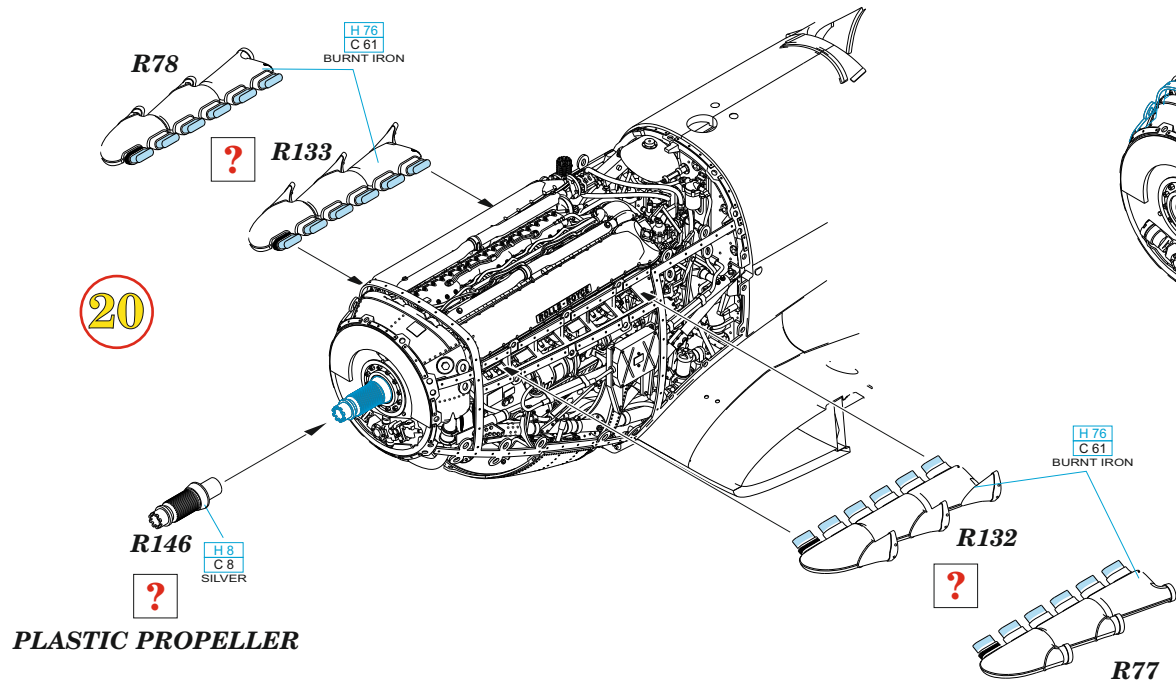

PLASTIC PROPELLER

COVERS

INNER SIDES - C 364
GRAY-GREEN

OUTER SIDES - CAMOUFLAGE COLOR

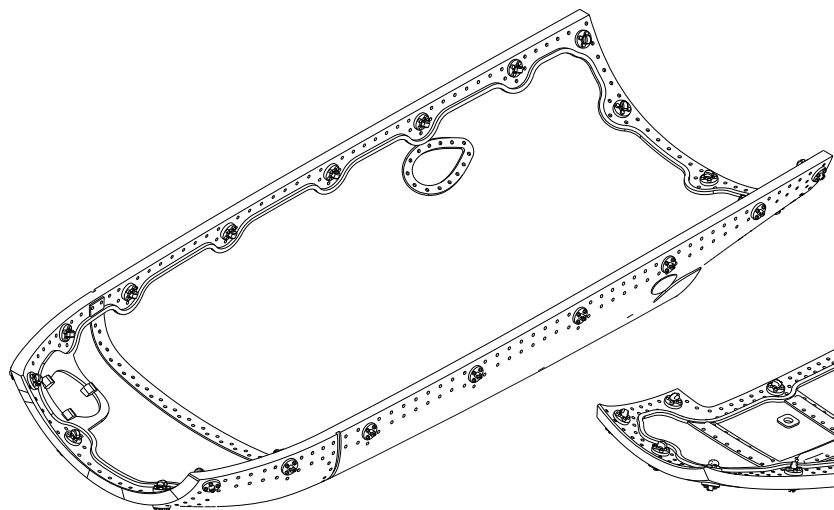

R67

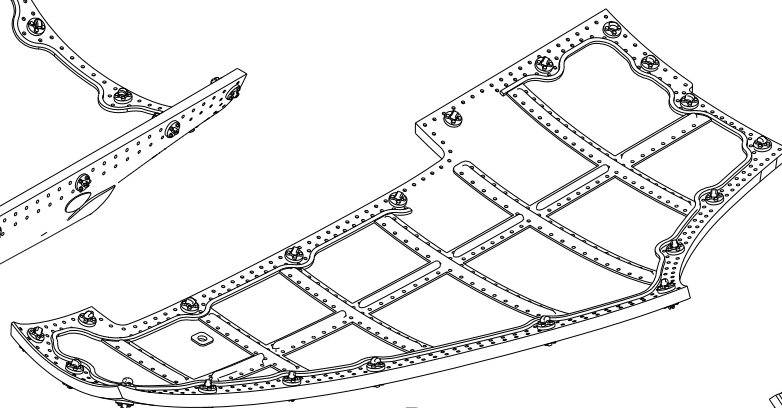

R161

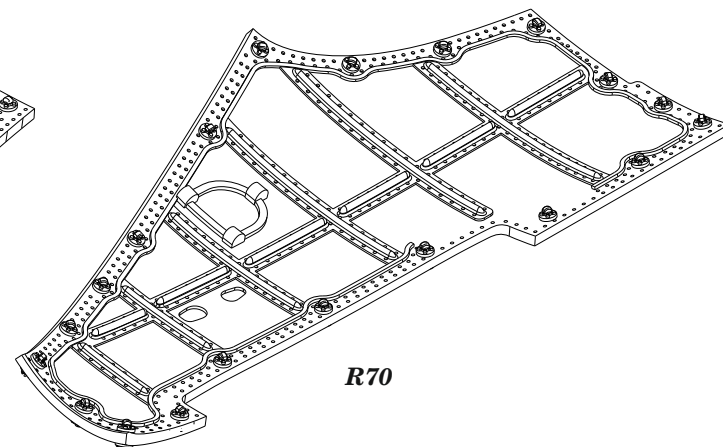

R70

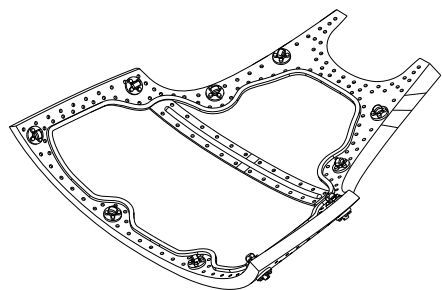

R69

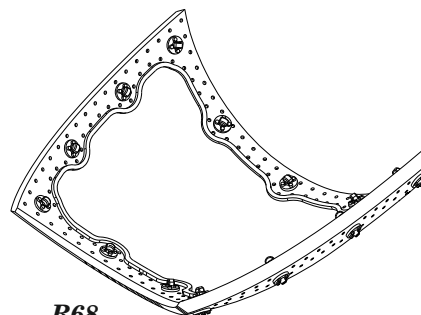

R68