

eduard
MASK

A6M5 Zero

The die-cut mask for accurate canopy frame painting of the
Hasegawa 1/48 KIT

EX 040

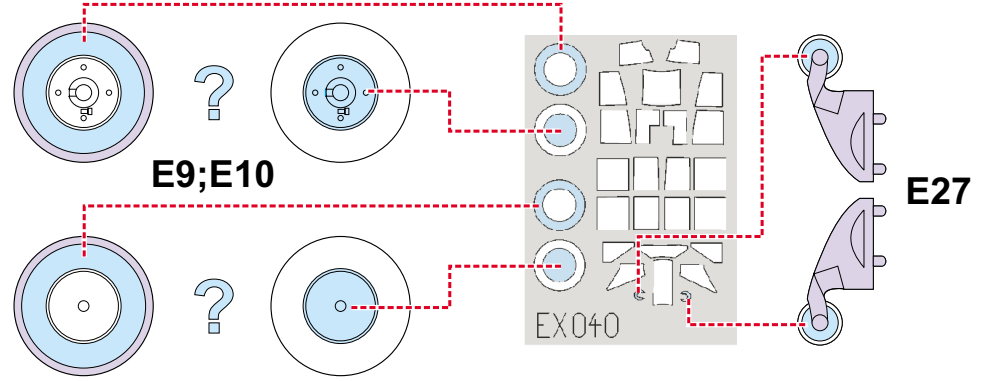
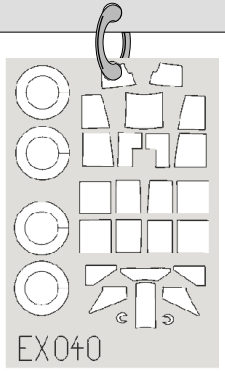

- LIQUID MASK

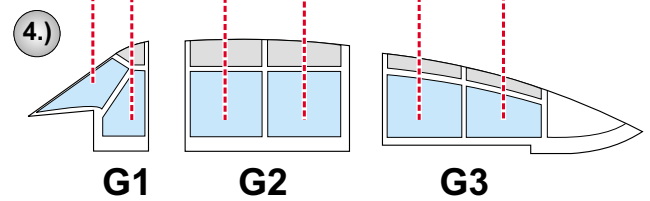
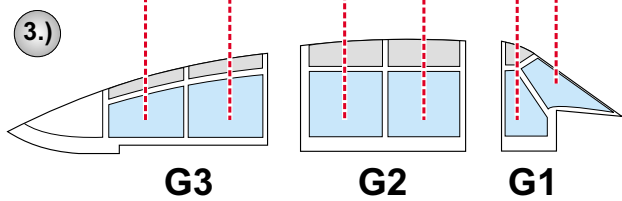
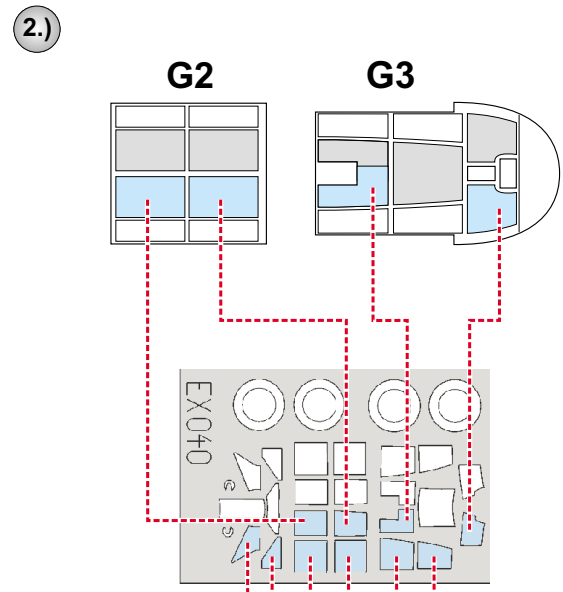
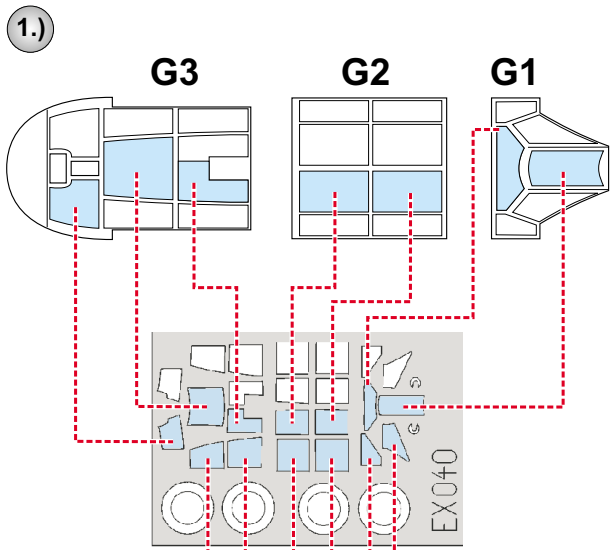

5.)
INTERIOR COLOR

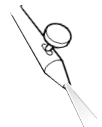

6.)
CAMOUFLAGE COLOR

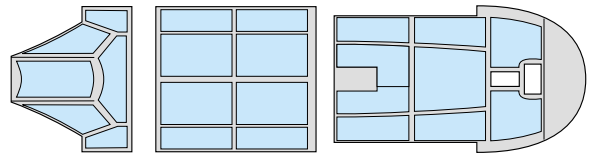

REFERENCES: - THE MARU MECHANIC #1 / 1980
- AERO DETAIL #7